

## ADAPT2FIT COMPONENTS

|  |  |   |  |
|--|--|---|--|
|  Thumbscrew                |  Handle         |  E-Brake       |  Base Plate (2) |
|  Threaded Rod with L-Plate |  Carriage       |  Boot          |  Teflon Pad     |
|  Sterilization Tray        |  Connector Link |  Drop Pins (4) |  Clamp          |

## CARRIAGE REMOVAL

### Opt 1: End Removal

- 1** **A)** Unscrew the Thumbscrew with attached spring and remove the handle. **B)** Unscrew entire threaded rod with L-Plate using your fingers. If threaded rod with L-Plate is too tight to remove with fingers, put the handle back on and turn counter-clockwise to loosen.

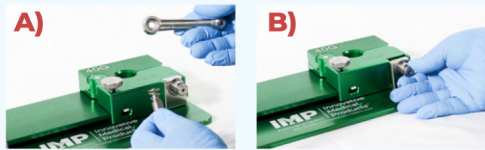

- 2** Slide the carriage toward the "Loading End" (right side) of the Base Plate and slide the carriage around the curved end of the top plate as indicated in the photo.



- 3** Unscrew the E-Break from the carriage. Do not remove Teflon pad.



### Opt 2: Middle Removal

- 1** **A)** With the 2 baseplates split apart, **B)** pull the carriage from the base plate.

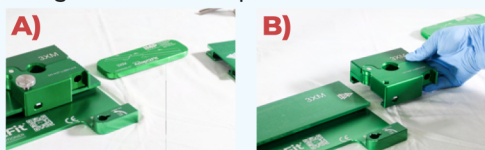

- 2** Remove the handle and E-Break for cleaning. Do not remove the Teflon pad.

## CARRIAGE REPLACEMENT

### Opt 1: End Replacement

- 1** **A)** While holding the Teflon Pad underneath the carriage, slide the carriage from the "Loading End" onto the base plate. **B)** Then slide the carriage around the curved end of the Base Plate.

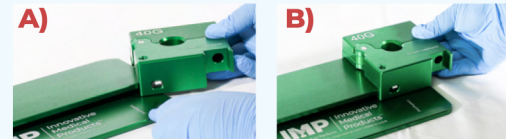

- 2** **A)** Using your fingers, screw in the threaded rod with L-Plate into the carriage until the threads of the rod catch the inside of the carriage. **B)** Insert boot ball into carriage and continue to tighten until finger tight.



- 3** **A)** Replace the handle in the 11 - 1 o'clock range and screw in the Thumbscrew with attached spring until tight. **B)** **C)** The handle now becomes a spring-loaded handle.

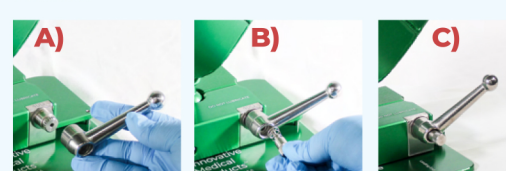

- 4** With the boot locked into the carriage, pull the spring-loaded handle out and turn either clockwise or counter-clockwise to make any final adjustments. Screw the E-Brake into the carriage.



### Opt 2: Middle Replacement

- 1** **A)** While holding the Teflon Pad against the carriage, **B)** slide the carriage onto the left-hand Baseplate.

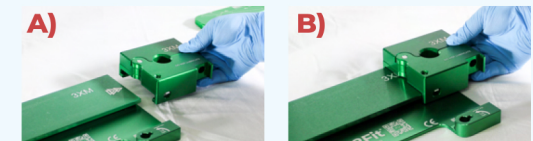

Continue with steps 2-4

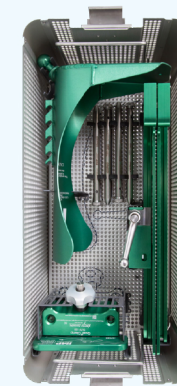

Before and After assembly, ensure that all Adapt2Fit components are present.

DE MAYO  
**Adapt2Fit®**  
MODULAR KNEE POSITIONER

This guide is for the  
**Adapt2Fit Knee  
Positioner only.**  
No tools required.



Scan for additional  
documentation

Catalog Number **1020**  
Doc Title **INFO-IMP-0005**  
Version **1**

## SAFETY TEST

Unit must be safety tested before final processing.

- 1** Check that the handle locks the Boot Ball securely in the 12 - 3 o'clock range.

- 2** Check that the Boot can be removed and carriage can slide freely on the base plate when the handle is unlocked.

